

Specifications:

Poles	30 Poles
Pitch between poles	1.00mm
Rated Voltage	200V AC,DC
Rated Current	1A (AWG #30)
Withstand Voltage	500V AC/minute
Contact Resistance	40mΩ (MAX.)
Insulation Resistance	100MΩ (MIN.)
Temperature Range	-40~+80°C
Applicable Wire Range	AWG #30~#36

 RoHS II-specification and Halogen-free products.

Note: Not applicable to all parts. For specific safety and compliance issues, contact JWT for details.

A1005 Series 1.00mm pitch HSDT crimp terminal socket

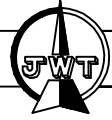

Features:

- * Material : Insulator: Thermal Plasticity Resin UL 94V-0
Shell: 0.15mm^t Copper Alloy, Tin plated
- * Suitable for JWT A1005 series terminal
- * JWT Part No.: A1005HS0-30P-**

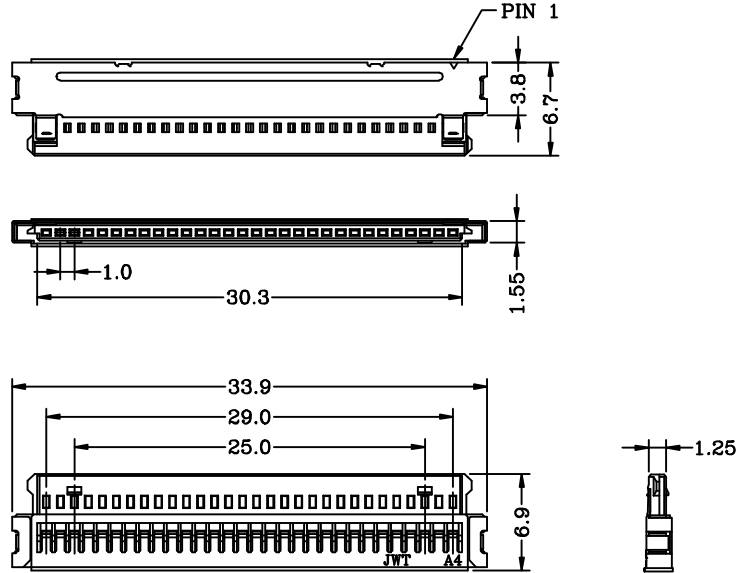

A1005 Series 1.00mm pitch HSDT crimp terminal

Features:

- * Used in JWT A1005 series socket

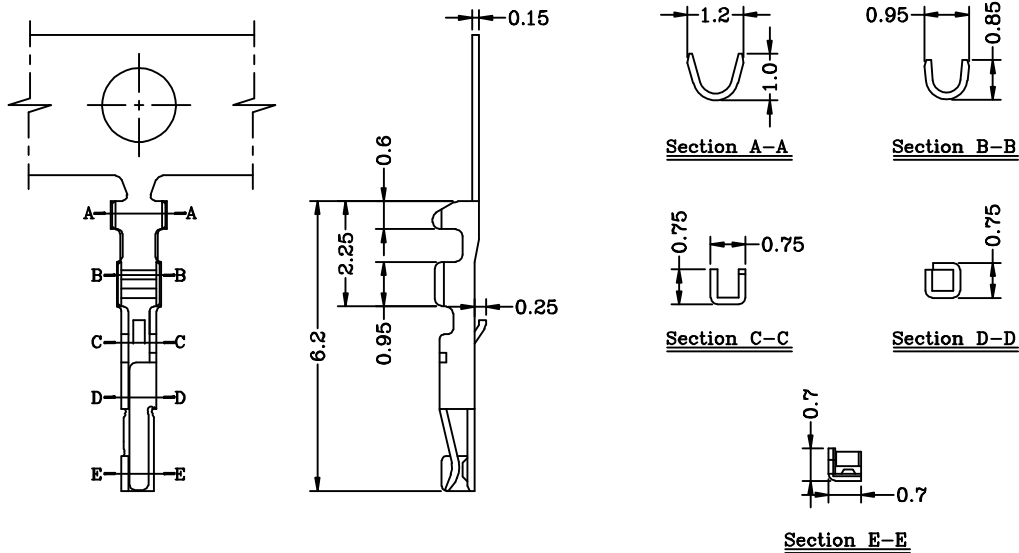

Specification & Ordering Information:

Part No	Wire Range	Insulation O.D.	Material	Finish	Qty/reel
A1005TOP-0*+	AWG #30~#36	0.75mm(max)	Phosphor bronze	Au over Nickel	20,000 pcs

Note: * (eg. 0, A, B...) designates Au-plate thickness identification.
For availability, delivery and MOQ, contact JWT.